

0-6-0 SADDLE TANK

5155

1971

5155B Reliance Rock Co.  
 5155C Oliver Iron Mining Co.  
 5155D Pennsylvania Railroad  
 5155E Santa Fe  
 5155F Baltimore & Ohio  
 5155G New York Central

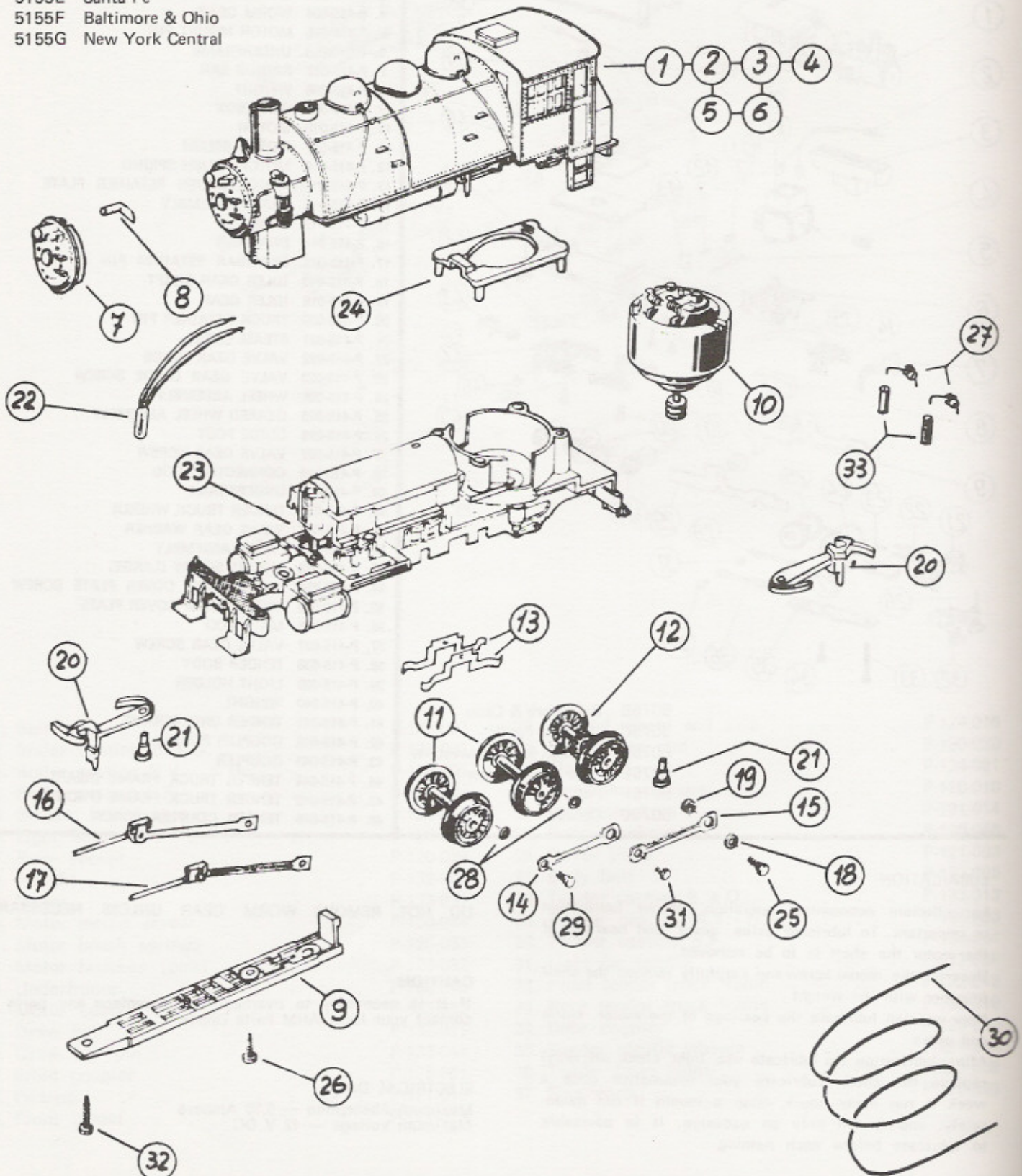





Here is a real little husky powerhouse that can be used any place and is ideal for working those tight yards or industries due to its wheel arrangement. For switching purposes, there are working X2f couplers front and rear and a headlight for night duty.

5155B Reliance Rock Co.  
5155C Oliver Iron Mining  
5155D P.R.R.

5155E A.T.S.F.  
5155F B & O  
5155G N.Y.C.

- |  |           |
|--|-----------|
| 1. BODY CASTING REL. ROCK. CO.....     | P-280-001 |
| 2. BODY CASTING OLIVER IRON M. CO..... | P-280-002 |
| 3. BODY CASTING P.R.R.....             | P-280-003 |
| 4. BODY CASTING SANTA FE.....          | P-280-004 |
| 5. BODY CASTING B & O.....             | P-280-005 |
| 6. BODY CASTING N.Y.C.....             | P-280-006 |
| 7. SMOKE BOY COVER.....                | P-280-007 |
| 8. LENS.....                           | P-280-009 |
| 9. COVER PLATE.....                    | P-280-008 |
| 10. MOTOR.....                         | P-280-010 |
|  |           |
| 11. FRONT AND CENTER DRIVERS.....      | P-280-011 |
| 12. GEARED DRIVERS.....                | P-280-013 |
| 13. PICK UP.....                       | P-280-014 |
| 14. FRONT CONNECTING ROD.....          | P-280-015 |
| 15. REAR CONNECTING ROD.....           | P-280-016 |
| 16. VALVE GEAR R. H.....               | P-280-017 |
| 17. VALVE GEAR L. H.....               | P-280-018 |
| 18. SPACER.....                        | P-280-019 |
| 19. SPACER.....                        | P-280-020 |
| 20. COUPLER.....                       | P-280-021 |
|  |           |
| 21. COUPLER PIN.....                   | P-280-022 |
| 22. BULB.....                          | P-280-023 |
| 23. UNDERFRAME W/WEIGHT.....           | P-280-024 |
| 24. MOTOR BRACKET.....                 | P-280-025 |
| 25. REAR CRANK PIN.....                | P-265-036 |
| 26. CENTER COVER PLATE SCREW.....      | P-120-008 |
| 27. BRUSH SPRINGS.....                 | P-120-033 |
| 28. CRANKPIN WASHER.....               | P-120-010 |
| 29. FRONT CRANKPIN.....                | P-121-014 |
| 30. UTRAFLEX WIRE.....                 | P-120-043 |
|  |           |
| 31. CENTER CRANKPIN.....               | P-126-046 |
| 32. COVER PLATE SCREW.....             | P-255-031 |
| 33. BRUSHES.....                       | P-120-032 |