

NAME

O-8-O SWITCHER

STOCK NO.

5082

PRODUCTION

1969

5082B Indiana Harbor Belt

5082C Santa Fe

5082D Missouri Pacific

5082E Reading

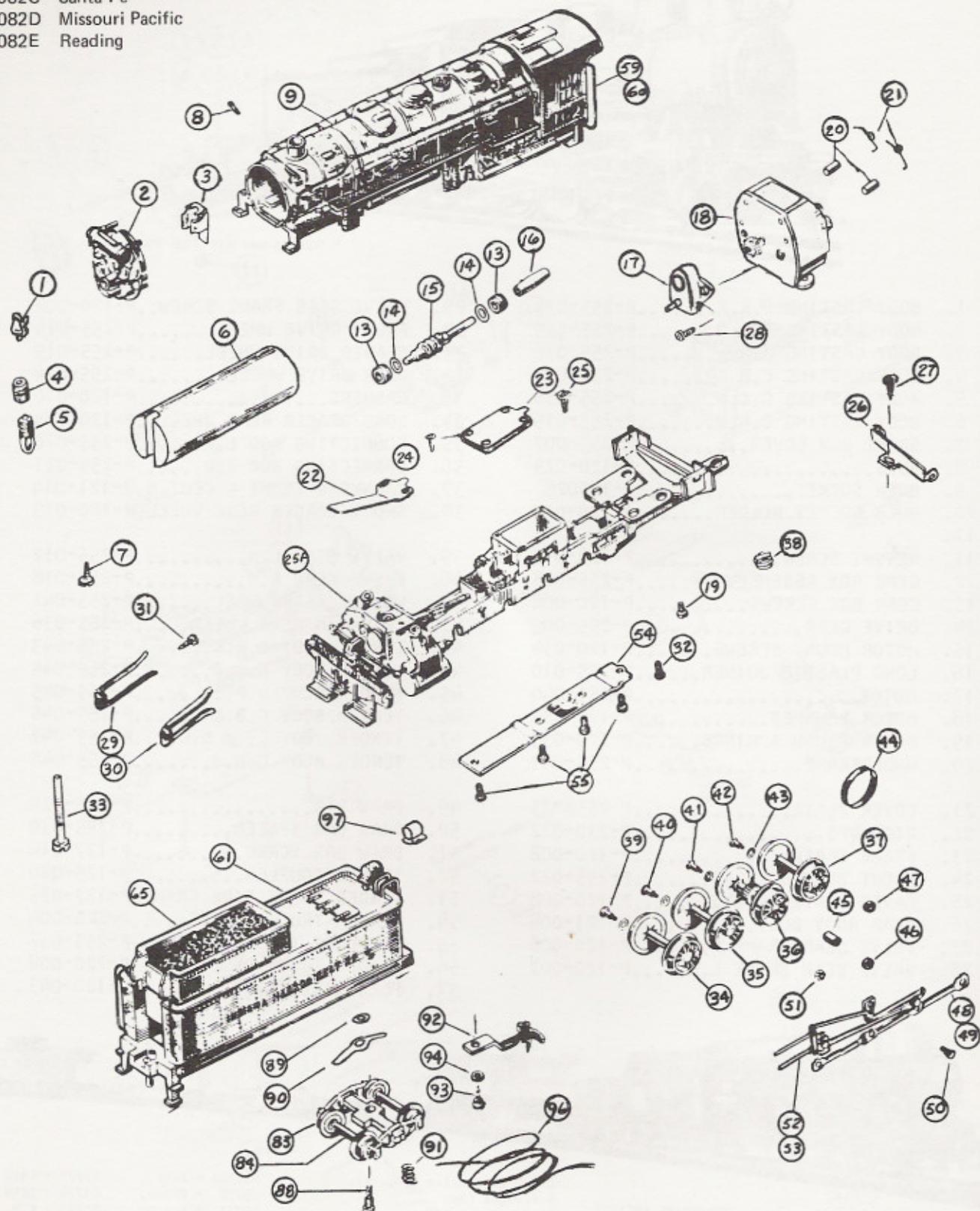

MODEL D2      MODEL D1

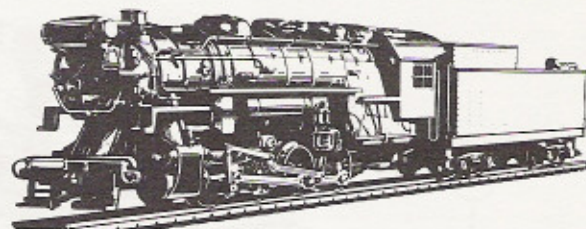

## 0-8-0 SWITCHER

Between 1918 and 1921 the United States Railroad Administration set forth rules which governed railroads in building new locomotives. Although most designs which were brought out by that administration became successes, one became an outstanding success. This was the 0-8-0. In 1927 the American Locomotive Company, Brooks Works, built the three cylinder switch locomotive which differed little from the U.S.R.A. design in appearance. These locomotives ultimately also became a big success. Total engine weight 264,000 lbs. (129,100 kg)      Length 1D - (27 cm)

	MODEL D2	MODEL D1
1.	BELL.....P-120-037...	SAME AS D2
2.	BOILER FRONT.....P-137-001...	SAME AS D2
3.	BULB SOCKET HOLDER.....P-120-027...	SAME AS D2
4.	BULB SOCKET.....P-120-028...	SAME AS D2
5.	BULB.....P-120-029...	SAME AS D2
6.	WEIGHT.....P-137-019...	SAME AS D2
7.	SCREW FOR WEIGHT.....P-137-020...	SAME AS D2
8.	HANDRAIL BRACKET.....P-120-039...	SAME AS D2
9.	BOILER CASTING (LHB).....P-137-002...	SAME AS D2
10.	BOILER CASTING (SF).....P-137-003...	SAME AS D2
11.	BOILER CASTING (MP).....P-137-002...	SAME AS D2
12.	BOILER CASTING (READING).....P-137-002...	SAME AS D2
13.	BEARING.....P-127-035...	SAME AS D2
14.	WASHER.....P-128-034...	SAME AS D2
15.	WORM.....P-137-004...	SAME AS D2
16.	PLASTIC TUBE.....P-137-005...	SAME AS D2
17.	REDUCTION BOX W/GEAR.....P-137-006...	SAME AS D2
18.	MOTOR.....P-137-007...	SAME AS D2
19.	SCREW TO MOUNT MOTOR.....P-120-034...	SAME AS D2
20.	MOTOR BRUSCHES (PAIR).....P-120-032...	SAME AS D2
21.	MOTOR BRUSH SPRINGS.....P-120-033...	SAME AS D2
22.	CONTACT PLATE.....P-137-008...	SAME AS D2
23.	GEAR BOX COVER.....P-137-009...	SAME AS D2
24.	FRONT SCREWS FOR G. B.....P-126-031...	SAME AS D2
25.	REAR SCREWS FOR G. B.....P-137-010...	SAME AS D2
25A.	UNDERFRAME.....P-137-040...	SAME AS D2
26.	VALVE GEAR HANGAR.....P-127-027...	SAME AS D2
27.	SCREW FOR V.G. HANGAR.....P-121-004...	SAME AS D2
28.	SCREW.....P-137-062...	P-137-011
29.	VALVE GEAR FRAME (RH).....P-137-012...	SAME AS D2
30.	VALVE GEAR FRAME (LH).....P-137-013...	SAME AS D2
31.	VALVE GEAR FRAME SCREW.....P-137-014...	SAME AS D2
32.	SMALL BODY SCREW.....P-137-015...	SAME AS D2
33.	LARGE BODY SCREW.....P-137-016...	SAME AS D2
34.	FRONT WHEELS AXLE.....P-121-013...	SAME AS D2
35.	2ND WHEELS & AXLE.....P-137-053...	SAME AS D2
36.	GEARED AXLE & WHEELS.....P-137-017...	P-136-017
37.	REAR WHEEL & AXLE.....P-137-054...	SAME AS D2
38.	REAR WHEEL SPRING.....P-137-018...	SAME AS D2
39.	CRANK PIN FRONT DRIVER.....P-121-014...	SAME AS D2
40.	CRANK PIN SEC. DRIVER.....P-126-070...	SAME AS D2
41.	CRANK PIN GEARED DRIVER.....P-122-017...	P-120-017
42.	CRANK PIN REAR DRIVE.....P-126-046...	SAME AS D2
43.	CRANK PIN WASHER.....P-120-010...	SAME AS D2
44.	TIRE.....P-126-045...	SAME AS D2
45.	LONG SPACER.....P-120-018...	SAME AS D2
46.	SHORT SPACER.....P-120-019...	SAME AS D2
47.	REAR SPACER.....P-126-021...	SAME AS D2
48.	CONNECTING ROD (RH).....P-126-022...	SAME AS D2
49.	CONNECTING ROD (LH).....P-126-023...	SAME AS D2
50.	VALVE GEAR HANG. BOLT.....P-121-024...	SAME AS D2
51.	VALVE GEAR HANG. NUT.....P-121-025...	SAME AS D2
52.	VALVE GEAR (RH).....P-137-021...	P-136-021
53.	VALVE GEAR (LH).....P-137-022...	P-136-022
54.	COVER PLATE.....P-137-023...	SAME AS D2
55.	COVER PLATE SCREWS.....P-137-015...	SAME AS D2
56.	DRAW BAR.....NONE	NONE
57.	DRAW BAR SCREW.....NONE	NONE
58.	DRAW BAR NUT.....NONE	NONE
59.	REAR HANDRAIL (RH).....P-137-024...	SAME AS D2
60.	REAR HANDRAIL (LH).....P-137-052...	SAME AS D2

MODEL D2

MODEL D1

61.	TENDER SHELL (LHB).....P-137-025	Same as D2
62.	TENDER SHELL (SF).....P-137-026	Same as D2
63.	TENDER SHELL (MP).....P-137-027	Same as D2
64.	TENDER SHELL (READING).....P-137-028	Same as D2
65.	COAL BIN FRO TENDER.....P-137-029	Same as D2
66.	RUBBER DRIVE COUPLING.....NONE	NONE
67.	PLASTIC COUPLING.....NONE	NONE
67A.	CENTER PLASTIC COUPLER.....NONE	NONE
68.	METAL TUBE COUPLER.....NONE	NONE
69.	BOLT FOR TENDER DRAW BAR.....NONE	NONE
70.	NUT FOR TENDER DRAW BAR.....NONE	NONE
71.	DRIVE GEAR.....NONE	NONE
72.	MOTOR WITH GEAR.....NONE	NONE
73.	BEARING.....NONE	NONE
74.	GEAR BOX COVER.....NONE	NONE
75.	SCREWS FOR G.B. COVER.....NONE	NONE
76.	GASKET FOR GEAR BOX.....NONE	NONE
77.	MOTOR OR MOUNT SCREW.....NONE	NONE
78.	MOTOR BRUSHES.....NONE	NONE
79.	MOTOR BRUSH SPRING.....NONE	NONE
80.	TENDER STEPS.....NONE	NONE
81.	LEADS W/JACKS.....NONE	NONE
82.	UNDERFRAME.....NONE	NONE
83.	TENDER TRUCK FRAME.....P-137-035	Same as D2
84.	TENDER TRUCK WHEELS.....P-137-036	Same as D2
85.	TRUCK SIDE FRAME.....NONE	NONE
86.	TRUCK SPRING.....NONE	NONE
87.	CROSS BAR.....NONE	NONE
88.	TRUCK SCREW.....P-137-056	P-137-037
89.	WASHER FOR TRUCK.....P-137-055	P-160-053
90.	PICK UP FOR TRUCK.....P-137-060	P-137-038
91.	BOLSTER SPRING.....P-126-064	Same as D2
92.	REAR COUPLER.....P-140-001	P-126-077
93.	REAR COUPLER SCREW.....NONE	P-121-008
94.	COUPLER SPACER.....NONE	P-132-012
95.	COUPLER WASHER.....NONE	NONE
96.	FLEX WIRE.....NONE	NONE
97.	LIGHT FOR TENDER.....P-137-039	Same As D2
98.	DRIVE GEAR SPACE SMALLL.....P-137-057	
99.	DRIVE GEAR SPACER LARGE.....P-126-069	
100.	COMPLETE TENDER TRUCK REAR.....P-137-061	P-126-057
101.	REAR TENDER TRUCK FRAME.....P-137-059	
102.	MOTOR BRACKET.....P-137-058	