

NAME
2-10-2 CLASS S-1

STOCK NO.
5099

PRODUCTION
1966

5099B Baltimore & Ohio

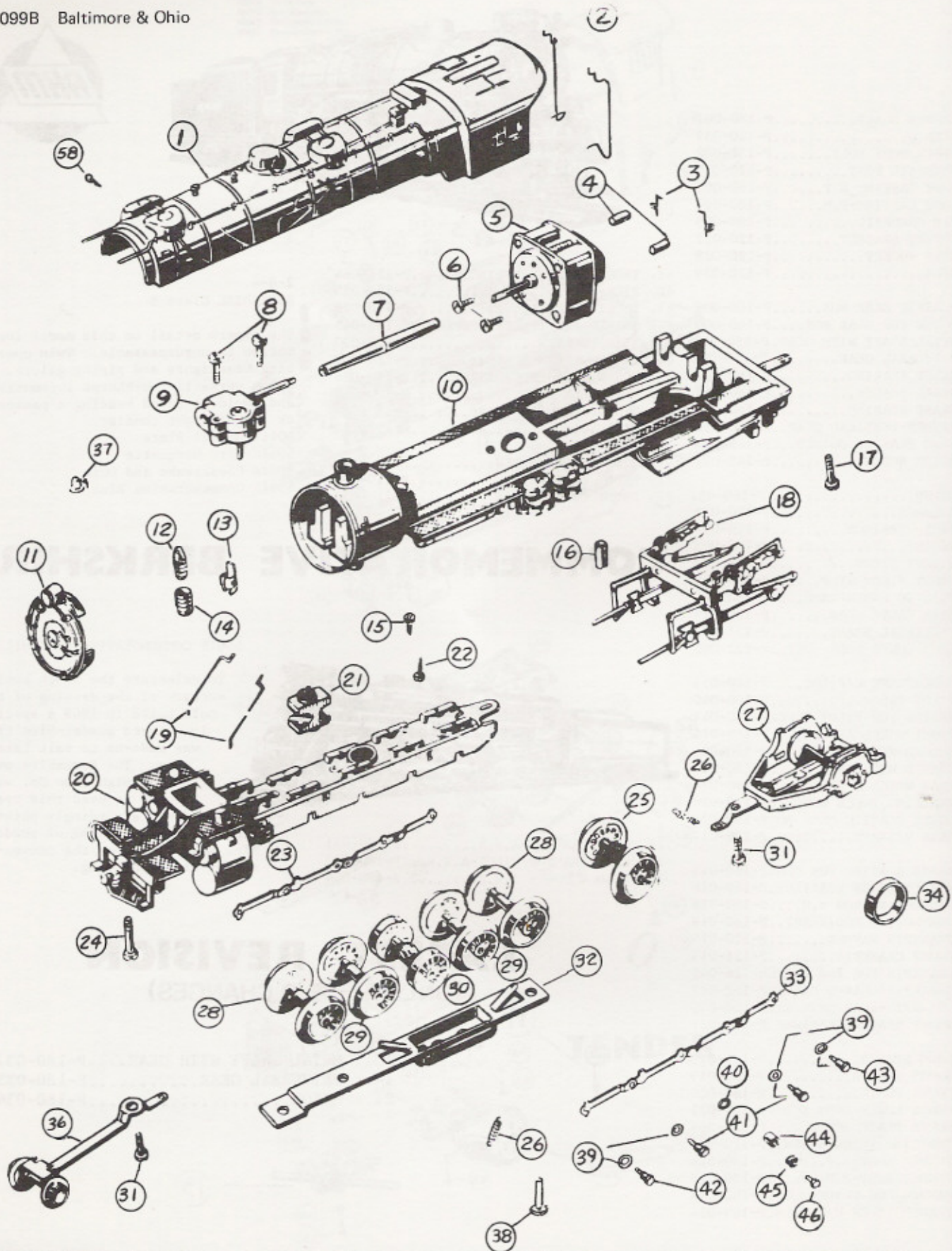

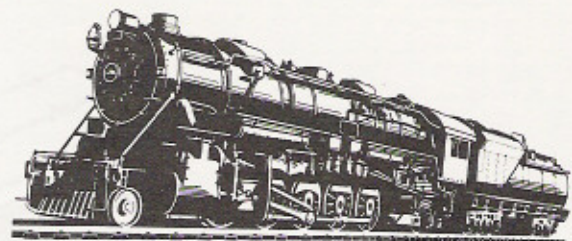
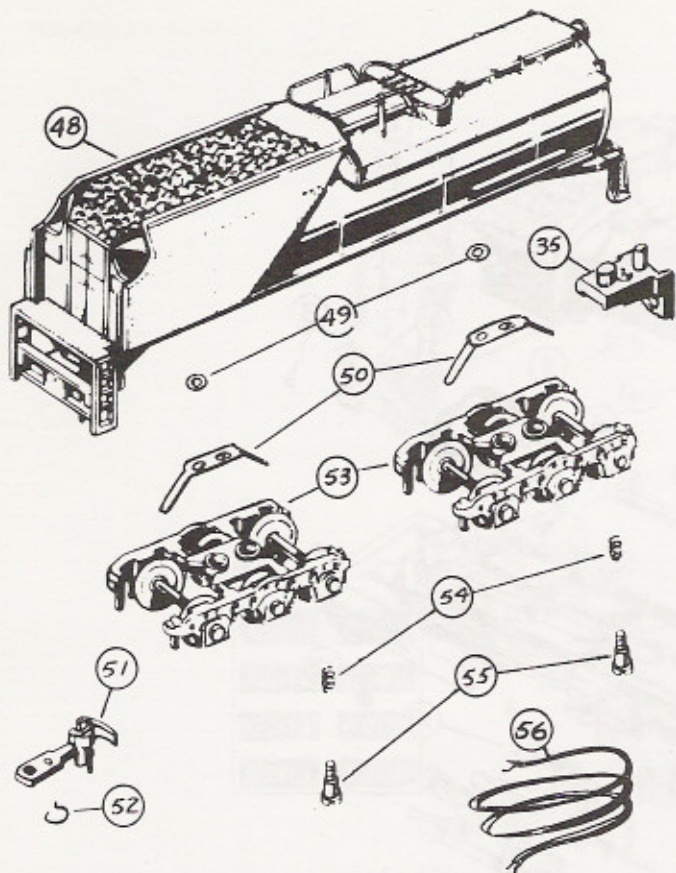

"Big Sixes", they called them out on the Cumberland, Pittsburgh, New Castle and Toledo divisions. "Big," because they were big, and the numbers always started with the number six; that is until 1956 when the few left were changed to the 500 series. The first Santa Fe was built for the B & O in 1914.

Because of sharp curves many locomotives were built without flanged center driver. Our model has an extra flanged center driver for model railroaders wishing to convert to an all-flanged model. Length with tender 15"

47	6200	6200
	6202	6202
	6204	6204
	6208	6208

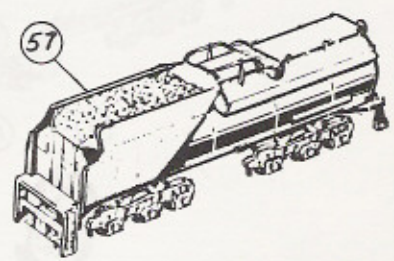

<ol style="list-style-type: none"> 1. BOILER CASTING P-250-001 2. CAB HANDRAILS (2) P-250-002 3. MOTOR BRUSH SPRINGS P-120-033 4. MOTOR BRUSHES (2) P-245-017 5. MOTOR P-245-016 6. MOTOR MOUNT SCREW P-245-015 7. LONG PLASTIC JOINER P-160-014 8. SCREWS FOR GEARBOX ASSEMBLY P-160-009 9. GEARBOX ASSEMBLY P-250-003 10. UNDERFRAME W/WEIGHT P-250-005 11. SMOKE BOX COVER P-250-004 12. BULB P-120-029 13. BULB SOCKET HOLDER P-120-027 14. BULB SOCKET P-120-028 15. MAIN VALVE GEAR SCREW P-160-044 16. UNIVERSAL SHAFT P-137-005 17. REAR BODY SCREW P-132-005 18. MAIN VALVE GEAR W/CROSSBAR P-250-006 19. PILOT HANDRAILS (2) P-250-007 20. METAL UNDERFRAME W/PILOT P-250-008 21. LOWER GEARBOX ASSEMBLY P-250-009 22. REAR UNDERFRAME SCREW P-121-008 23. CONNECTING ROD R/H P-250-010 24. FRONT LOWER BODY SCREW P-127-020 25. GEARDRIVER-PLANGED P-250-011 26. PILOT AND TRAILING TRUCK SPRING P-160-041 27. TRAILING TRUCK P-250-012 28. FRONT AND REAR DRIVERS P-250-013 29. SECOND AND FOURTH DRIVERS P-250-014 30. GEARDRIVER -BLIND P-250-015 	<ol style="list-style-type: none"> 31. PILOT AND TRAILING TRUCK SCREW P-245-050 32. COVERPLATE P-250-016 33. CONNECTING ROD L/H P-250-017 34. TRACTION TIRE P-126-045 35. TENDER COUPLER POCKET P-250-022 36. PILOT TRUCK P-250-018 37. BELL P-120-037 38. COVERPLATE SCREW P-245-064 39. CRACKPIN WASHERS (4) P-120-010 40. WASHER FOR GEARDRIVER P-120-015 41. SECOND AND FOURTH CRANKPIN P-126-020 42. FRONT CRANKPIN P-230-032 43. REAR CRANKPIN P-120-014 44. LARGE SPACER P-120-018 45. SMALL SPACER P-120-019 46. GEARDRIVER CRANKPIN P-122-017 47. DECALS P-250-019 48. TENDER BODY P-250-020 49. TENDER BODY TRUCK WASHERS P-160-053 50. TENDER BODY TRUCK PICKUPS P-160-055 51. TENDER COUPLER P-140-001 52. TENDER COUPLER SPRINGS (6) P-140-002 53. COMPLETE TENDER TRUCK (2) P-250-021 54. BOLSTER SPRINGS P-126-064 55. TRUCK SCREWS P-160-056 56. FLEX WIRE P-120-043 57. COMPLETE TENDER 5098 58. HANDRAIL POST P-120-039
---	---