

5114B Union Pacific

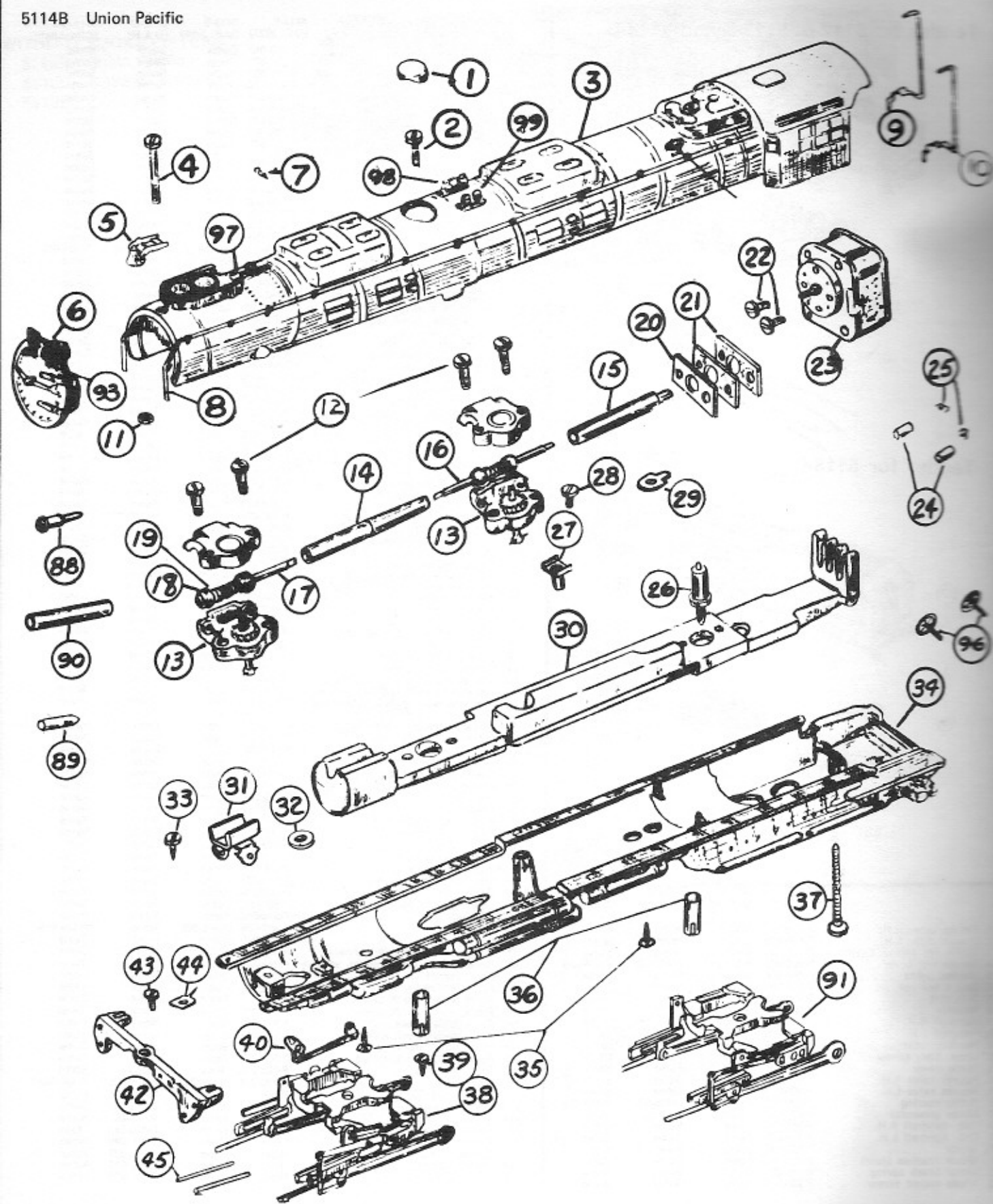

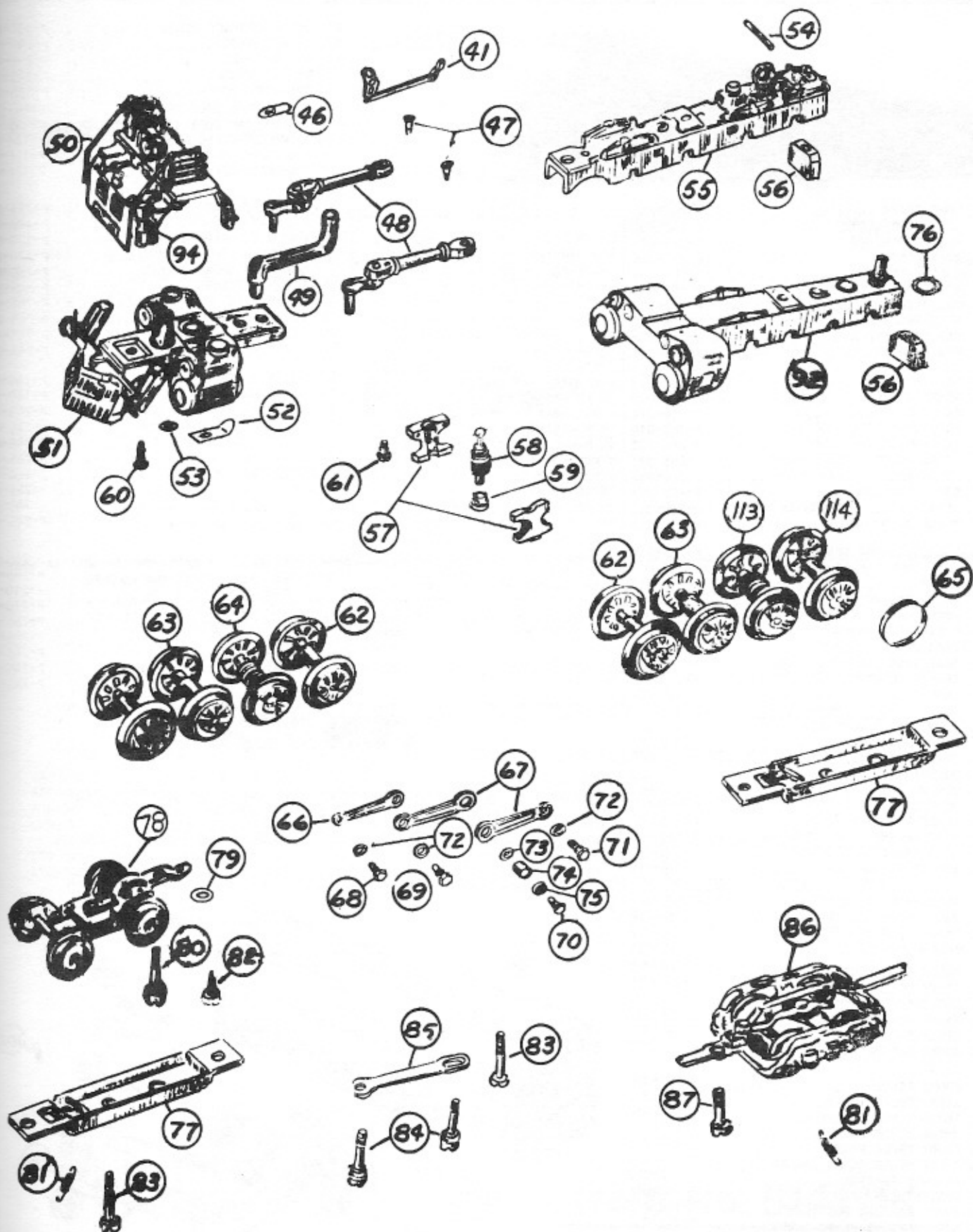



1. DOME COVER .....	P-245-001
2. UPPER BODY SCREW .....	P-160-002
3. BOILER CASTING .....	P-245-002
4. BELL BOLT .....	P-245-003
5. BELL & BRACKET .....	P-245-004
6. SMOKE BOX COVER .....	P-245-005
7. HANDRAIL POST .....	P-120-039
8. HANDRAIL .....	P-245-006
9. CAB HANDRAIL RIGHT .....	P-245-007
10. CAB HANDRAIL LEFT .....	P-245-008
11. BELL BOLT NUT .....	P-245-009
12. GEARBOX SCREW .....	P-160-009
13. GEARBOX W/GEAR .....	P-210-022
14. PLASTIC JOINER LONG .....	P-160-014
15. PLASTIC JOINER SHORT .....	P-245-010
16. METAL SHAFT W/GEAR REAR .....	P-245-011
17. METAL SHAFT W/GEAR FRONT .....	P-245-012
18. BRASS BEARING .....	P-160-012
19. METAL SPACER HORIZONTAL SHAFT ..	P-160-013
20. METAL MOTOR SPACER .....	P-245-013
21. PLASTIC MOTOR SPACER .....	P-245-014
22. MOTOR MOUNT SCREWS .....	P-245-015
23. MOTOR .....	P-245-016
24. MOTOR BRUSHES .....	P-245-017
25. MOTOR BRUSH SPRINGS .....	P-120-033
26. CYLINDER CONTACT .....	P-210-023
27. REAR TRUCK SUPPORT .....	P-245-018
28. REAR TRUCK SUPPORT SCREW .....	P-160-044
29. SUPPORT CONTACT .....	P-245-019
30. WEIGHT .....	P-245-020
31. FRONT TRUCK BRACKET .....	P-245-022
32. BRASS WASHER .....	P-245-021
33. BRACKET SCREW .....	P-120-008
34. UNDERFRAME .....	P-245-023
35. WEIGHT JOINT .....	P-210-056
36. UNIVERSAL JOINT .....	P-160-027
37. LOWER BODY SCREW LONG .....	P-180-012
38. MAIN VALVE GEAR W/CROSSBAR .....	P-245-024
39. MAIN VALVE GEAR SCREW .....	P-245-025
40. ECCENTRIC ROD LEFT .....	P-245-026
41. ECCENTRIC ROD RIGHT .....	P-245-027
42. VALVE GEAR HANGER .....	P-245-028
43. VALVE GEAR HANGER SCREW .....	P-161-020
44. WIRE CONTACTS .....	P-245-029
45. VALVE GEAR PINS .....	P-245-030
46. LIGHT BULB .....	P-160-034
47. ECCENTRIC ROD SCREWS .....	P-210-057
48. FRONT CYLINDER EXHAUST PIPE .....	P-245-032
49. STEAM PIPES .....	P-245-031
50. FRONT DECK & PUMP ASSEMBLY .....	P-245-033
51. FRONT PILOT .....	P-245-034
52. BULB CONTACT PLATE .....	P-245-035
53. CONTACT PLACE WASHER .....	P-245-036
54. METAL PIVOT SCREW .....	P-245-037
55. FRONT TRUCK FRAME .....	P-245-038
56. COVER PLATE SCREW SPACER .....	P-245-039
57. PLASTIC GEARBOX .....	P-160-038
58. UNIVERSAL W/GEAR .....	P-160-039
59. BRASS BEARING FOR GEAR .....	P-160-015
60. BULB CONTACT PLATE SCREW .....	P-200-018

UNION PACIFIC's world renowned, 4000 Series. BIG BOYS, were the heaviest locomotives produced in steam's finest hour and the only engines of their 4-8-8-4 wheel arrangement. The 25 ALCO locomotives earned Union Pacific enormous press radio and television coverage. U.P. men said they were able to run as fast as 80 MPH, although they developed their best HP at 30. It seems only fitting that a special place of honor should be reserved on every model railroader's lay-out for the largest and heaviest of "Iron Horses" of them all, the Union Pacific's BIG BOY. They have become the very symbol of survival for steam. It was the confirmed belief of many railfans and steam historians alike that, when the BIG BOYS passed out of existence, the story of steam will have ended in the United States. The year 1958 saw the last operation of the BIG BOYS. The symbol had fallen and steam was gone. Length with tender 18 1/2"

61. PILOT CONTACT SCREW .....	P-160-044
62. FRONT WHEELS .....	P-245-040
63. SECOND WHEEL .....	P-245-041
64. GEARED WHEEL .....	P-245-042
65. TRACTION TIRES .....	P-155-032
66. CONNECTING RODS FRONT .....	P-245-043
67. CONNECTING RODS CENTER & REAR ..	P-245-044
68. CRANKPIN FRONT DRIVER .....	P-121-014
69. CRANKPIN SECOND DRIVER .....	P-126-046
70. CRANKPIN GEARED DRIVER .....	P-122-017

71. CRANKPIN REAR DRIVER .....	P-126-020
72. CRANKPIN WASHERS .....	P-120-010
73. CRANKPIN WASHERS .....	P-120-015
74. CRANKPIN LONG SPACER .....	P-120-018
75. CRANKPIN SHORT SPACER .....	P-180-029
76. KINGPIN SPACER .....	P-245-045
77. COVERPLATE .....	P-245-046
78. PILOT TRUCK .....	P-245-047
79. PILOT TRUCK WASHER .....	P-245-048
80. PILOT TRUCK SCREW .....	P-245-049

81. PILOT TRUCK SPRING .....	P-160-041
82. WIRE CONTACT SCREW FRONT TRUCK ..	P-160-044
83. CENTER COVERPLATE SCREW .....	P-245-064
84. TRUCK CONNECTOR SCREW .....	P-245-050
85. TRUCK CONNECTOR .....	P-245-051
86. TRAILING TRUCK .....	P-245-052
87. TRAILING TRUCK SCREW .....	P-160-009
88. LIGHT PLUG .....	P-245-059
89. JACK FOR LIGHT PLUG .....	P-245-060
90. INSULATOR FOR JACK .....	P-245-061

91. SECOND MAIN VALVE GEAR W/CROSSBAR	P-245-062
92. REAR TRUCK FRAME W/STEAMCHEST ..	P-245-063
93. MARKER LIGHTS .....	P-210-008
94. STEAM COMPRESSORS .....	P-210-009
95. MOTOR GENERATOR .....	P-245-065
96. VALVE COCK .....	P-245-066
97. WHISTLE .....	P-245-068
98. POPPET VALVE R/H .....	P-245-068
99. POPPET VALVE L/H .....	P-245-069

## TENDER

31. FRONT TRUCK BRACKET .....	P-245-022
32. BRASS WASHER .....	P-245-021
33. BRACKET SCREW .....	P-120-008
34. UNDERFRAME .....	P-245-023
35. WEIGHT JOINT .....	P-210-056
36. UNIVERSAL JOINT .....	P-160-027
37. LOWER BODY SCREW LONG .....	P-180-012
38. MAIN VALVE GEAR W/CROSSBAR .....	P-245-024
39. MAIN VALVE GEAR SCREW .....	P-245-025
40. ECCENTRIC ROD LEFT .....	P-245-026
41. ECCENTRIC ROD RIGHT .....	P-245-027
42. VALVE GEAR HANGER .....	P-245-028
43. VALVE GEAR HANGER SCREW .....	P-161-020
44. WIRE CONTACTS .....	P-245-029
45. VALVE GEAR PINS .....	P-245-030
46. LIGHT BULB .....	P-160-034
47. ECCENTRIC ROD SCREWS .....	P-210-057
48. FRONT CYLINDER EXHAUST PIPE .....	P-245-032
49. STEAM PIPES .....	P-245-031
50. FRONT DECK & PUMP ASSEMBLY .....	P-245-033
51. FRONT PILOT .....	P-245-034
52. BULB CONTACT PLATE .....	P-245-035
53. CONTACT PLACE WASHER .....	P-245-036
54. METAL PIVOT SCREW .....	P-245-037
55. FRONT TRUCK FRAME .....	P-245-038
56. COVER PLATE SCREW SPACER .....	P-245-039
57. PLASTIC GEARBOX .....	P-160-038
58. UNIVERSAL W/GEAR .....	P-160-039
59. BRASS BEARING FOR GEAR .....	P-160-015
60. BULB CONTACT PLATE SCREW .....	P-200-018

100. TENDER SHELL .....	P-245-053
101. FRONT TENDER TRUCK .....	P-245-054
102. TRUCK SPRING .....	P-160-041
103. TRUCK WASHER .....	P-122-042
104. TRUCK SCREW .....	P-121-041
105. REAR TENDER TRUCK .....	P-245-055
106. FRONT & REAR WHEELS .....	P-245-056
107. SECOND & THIRD WHEELS .....	P-245-057

108. ULTRA FLEX WIRE .....	P-120-043
109. STANDARD COUPLER .....	P-245-058
110. HORNHOOK COUPLER .....	P-140-001
111. COUPLER SPRING .....	P-140-002
112. COMPLETE TENDER .....	P-5116
113. GEARED WHEEL W/TIRE .....	P-245-071
114. REAR WHEEL W/TIRE .....	P-245-072

