

NAME
BOWKER

STOCK NO. **5072**

PRODUCTION
1968

5072B Virginia & Truckee
 5072C Kansas City & St. Louis
 5072D Western & Atlantic
 5072E Beauford & Morehead
 5072F York & Peach Bottom
 5072G Belfast & Morehead

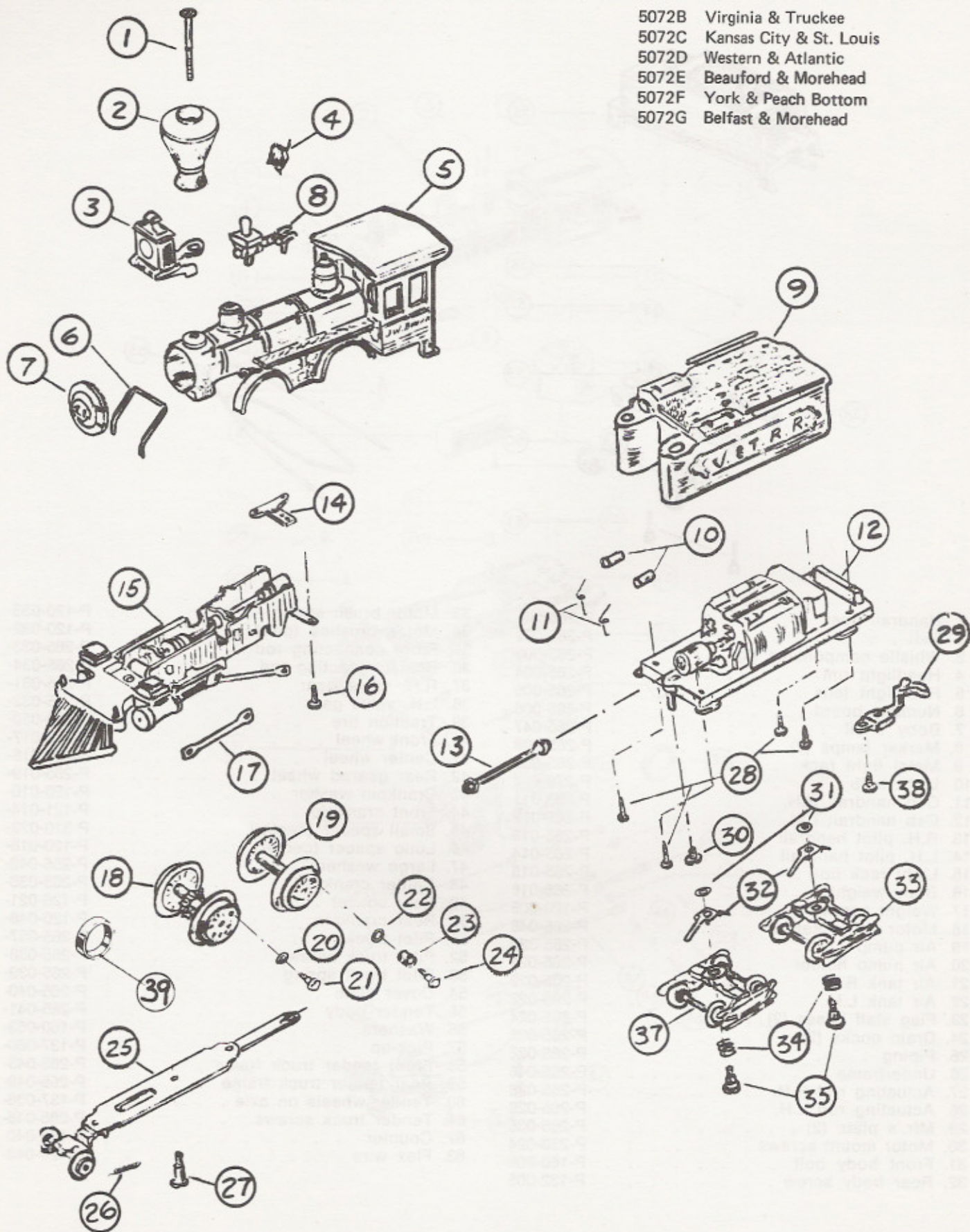

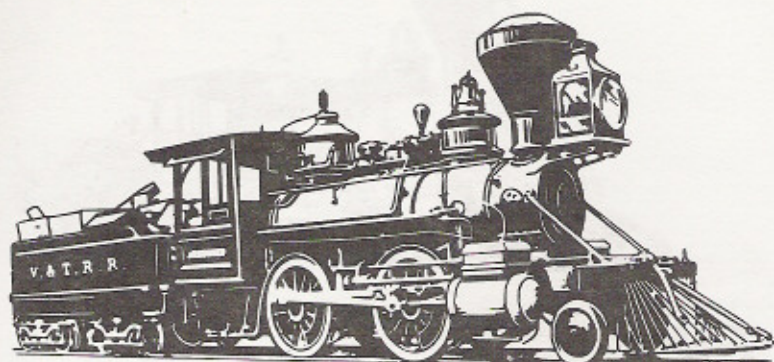

"BOWKER"

This locomotive was delivered by Baldwin in 1875, and was named for one of the veteran engineers. The switcher itself became, after a long and useful life on the Virginia and Truckee, the property of the Pacific Coast Chapter of the Railway and Locomotive Historical Society.

- | | |
|---------------------------------------|---------------------------------------|
| 1. SMOKE STACK SCREW.....P-240-001 | 21. CRANKPIN FRONT.....P-126-020 |
| 2. SMOKE STACK.....P-240-002 | 22. CRANKPIN WASHER.....P-120-010 |
| 3. LIGHT.....P-240-003 | 23. CRANKPIN SPACER.....P-240-009 |
| 4. BELL.....P-120-037 | 24. REAR CRANKPIN.....P-240-010 |
| 5. BOILER CASTING.....P-240-004 | 25. COVER PLATE W/TRUCK.....P-240-011 |
| 6. FRONT HANDRAIL.....P-240-005 | 26. LEAD TRUCK SPRING.....P-160-041 |
| 7. SMOKE BOX COVER.....P-240-006 | 27. COVER PLATE SCREW.....P-155-026 |
| 8. COMPRESSOR & WHISTLE.....P-240-012 | 28. TENDER BODY SCREW.....P-155-013 |
| 9. TENDER CASTING.....P-240-007 | 29. REAR COUPLER.....P-155-037 |
| 10. MOTOR BRUSHES.....P-120-032 | 30. DRAW BAR SCREW.....P-155-031 |
| 11. BRUSH SPRINGS.....P-120-033 | 31. TENDER TRUCK WASHER.....P-160-053 |
| 12. UNDER FRAME S/MOTOR.....P-155-030 | 32. TENDER TRUCK PICKUP.....P-155-045 |
| 13. DRIVE SHAFT.....P-155-027 | 33. TENDER TRUCK FRAME.....P-155-033 |
| 14. PICK UP.....P-155-015 | 34. TENSION SPRING.....P-126-064 |
| 15. UNDER FRAME W/SHAFT.....P-240-008 | 35. TENDER TRUCK SCREW(FD)..P-155-034 |
| 16. MOUNTING SCREW.....P-155-013 | 36. TENDER TRUCK SCREW(REAR,P-155-035 |
| 17. CONNECTING ROD.....P-155-024 | 37. TENDER TRUCK WHEELS.....P-155-036 |
| 18. FRONT DRIVE WHEEL.....P-155-019 | 38. COUPLER SCREW.....P-137-015 |
| 19. REAR WHEEL.....P-155-020 | 39. TRACTION TIRE.....P-155-032 |
| 20. CRANKPIN WASHER.....P-120-010 | |