

5092 .039 Small Flanges  
 5092B Norfolk & Western  
 5092C Undecorated

5090B Pennsylvania Railroad  
 5090C Santa Fe  
 5090D Norfolk & Western

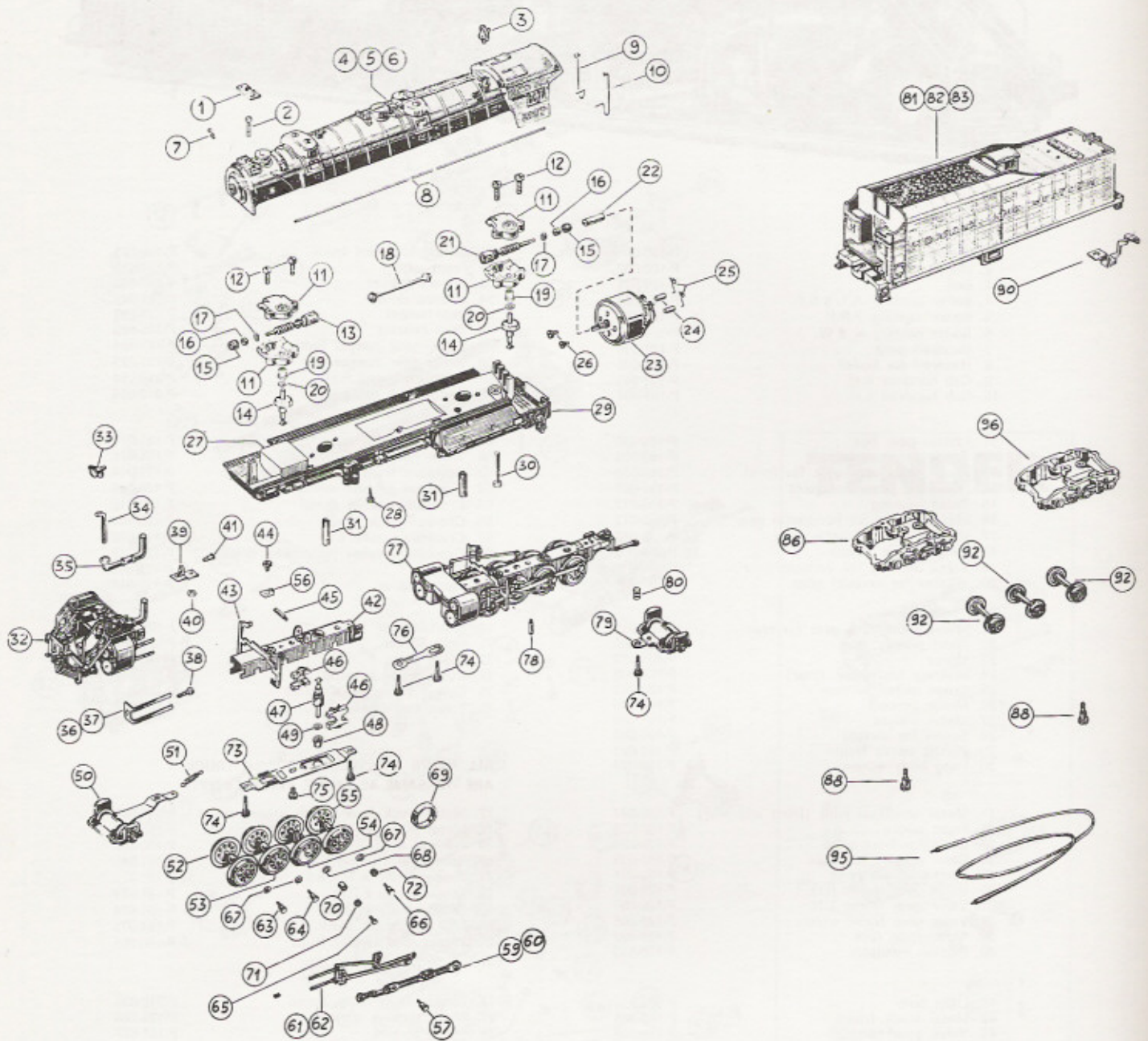

NAME

Y6B MALLET

STOCK NO.

5090,5092

PRODUCTION

1977

1. Steam box cover . . . . .	P-160-001	47. Universal with gear . . . . .	P-210-059
2. Upper body bolt . . . . .	P-160-002	48. Brass bearing for gear . . . . .	P-160-015
3. Bell . . . . .	P-120-037	49. Washer for vertical gear . . . . .	P-160-016
4. Boiler casting A.T. & S.F. . . . .	P-160-003	50. Pilot truck . . . . .	P-160-040
5. Boiler casting P.R.R. . . . .	P-160-004	51. Spring for pilot truck . . . . .	P-160-041
6. Boiler casting N. & W. . . . .	P-160-003	52. Front wheel . . . . .	P-137-072
7. Handrail post . . . . .	P-120-039	53. Second wheel . . . . .	P-137-053
8. Handrail for boiler . . . . .	P-160-006	54. Geared driver . . . . .	P-161-042
9. Cab handrail R.H. . . . .	P-161-005	55. Rear wheel . . . . .	P-137-053
10. Cab handrail L.H. . . . .	P-161-007	56. Wire contact . . . . .	P-245-029
11. Plastic gear box . . . . .	P-160-008	57. Valve gear hangar bolt . . . . .	P-133-024
12. Screw for gear box . . . . .	P-160-009	59. Connecting rod R.H. . . . .	P-210-054
13. Metal shaft with gear for front . . . . .	P-161-010	60. Connecting rod L.H. . . . .	P-210-055
14. Universal gear with joint . . . . .	P-161-067	61. Valve gear R.H. . . . .	P-161-077
15. Brass bearing . . . . .	P-160-012	62. Valve gear L.H. . . . .	P-161-078
16. Metal spacer for horizontal gear . . . . .	P-160-013	63. Crankpin front driver . . . . .	P-121-014
17. Washer for horizontal gear . . . . .	P-160-016	64. Crankpin second driver . . . . .	P-126-046
18. Long plastic joiner . . . . .	P-200-009	65. Crankpin geared driver . . . . .	P-122-017
19. Brass bearing for vertical gear . . . . .	P-160-015	66. Crankpin rear driver . . . . .	P-120-046
20. Washer for vertical gear . . . . .	P-161-068	67. Crankpin washers . . . . .	P-120-010
21. Metal shaft with gear for rear . . . . .	P-161-017	68. Crankpin washer for geared driver . . . . .	P-120-015
22. Short plastic joint . . . . .	P-137-005	69. Tire . . . . .	P-126-045
23. Motor . . . . .	P-161-057	70. Long spacer . . . . .	P-120-018
24. Brushes for motor (pair) . . . . .	P-120-032	71. Short spacer . . . . .	P-120-019
25. Brush motor springs . . . . .	P-120-033	72. Rear spacer . . . . .	P-126-021
26. Motor screws . . . . .	P-160-020	73. Cover plate . . . . .	P-160-043
27. Metal weight . . . . .	P-161-069	74. Cover plate screws . . . . .	P-210-052
28. Screw for weight . . . . .	P-120-008	75. Center cover plate screw . . . . .	P-160-044
29. Plastic under frame . . . . .	P-161-025	76. Truck connector . . . . .	P-161-045
30. Long body screw . . . . .	P-160-026		
31. Metal universal joint (front and rear) . . . . .	P-160-027	<b>ALL PARTS ON SECOND POWER TRUCK</b>	
32. Front pilot . . . . .	P-160-028	<b>ARE THE SAME AS ON THE FIRST, EXCEPT:</b>	
33. Lamp for front pilot . . . . .	P-160-029	77. Metal truck frame with steam chest . . . . .	P-161-046
34. Clear plastic for light . . . . .	P-160-030	78. Metal pivot screw . . . . .	P-161-079
35. Plastic steam hose . . . . .	P-160-031	79. Trailing truck . . . . .	P-160-063
36. Valve gear frame R.H. . . . .	P-120-006	80. Spring for trailing truck . . . . .	P-161-049
37. Valve gear frame L.H. . . . .	P-120-007	81. Tender body A.T. & S.F. . . . .	P-161-080
38. Valve gear frame screw . . . . .	P-120-008	82. Tender body P.R.R. . . . .	P-161-081
39. Metal light rack . . . . .	P-160-032	83. Tender body N. & W. . . . .	P-161-082
40. Plastic insulator . . . . .	P-160-033	86. Tender truck side frame (front) . . . . .	P-161-083
41. Light bulb . . . . .	P-160-034	88. Truck pin . . . . .	P-241-026
42. Metal truck frame . . . . .	P-160-035	90. Rear coupler . . . . .	P-125-040
43. Valve gear hangar . . . . .	P-160-036	92. Tender truck wheels . . . . .	P-161-076
44. Valve gear hangar screw . . . . .	P-160-019	95. Ultraflex wire . . . . .	P-120-043
45. Metal pivot screw . . . . .	P-160-037	96. Tender truck side frame (rear) . . . . .	P-161-084
46. Plastic gear box . . . . .	P-160-038		

STOCK NO. 5092

This locomotive is equipped with 039" flanged wheels and is recommended only for advanced railroaders using code 70 rail and only where such rail has been flawlessly laid. For normal operation we recommend our regular flanges which operate perfectly on standard code 100 track and other track generally commercially available.

This locomotive requires some special parts, listed below, instead of the correspondent ones listed on the general sheet part. Check carefully before maintenance operations.

50. Pilot truck with 039" flanged wheel . . . . .	P-161-085
52. Front wheel 039" flanged . . . . .	P-161-088
53. Second wheel 039" flanged . . . . .	P-161-089
54. Geared driver 039" flanged . . . . .	P-161-090
55. Rear wheel 039" flanged . . . . .	P-161-089
79. Trailing truck with 039" flanged wheel . . . . .	P-161-087
92. Tender truck wheels 039" flanged . . . . .	P-161-086